



Installation Manual

1968 Chevelle/Malibu

DOCUMENT #1-2049 BENCH CALIBRATION INSTRUCTIONS



1

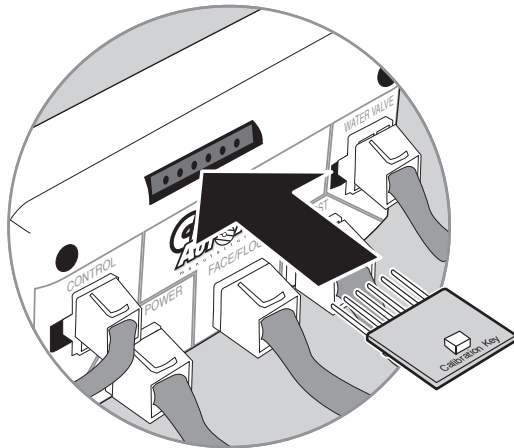

Insert Calibration Key as shown (LED up) into 6-pin connection in ECU

2

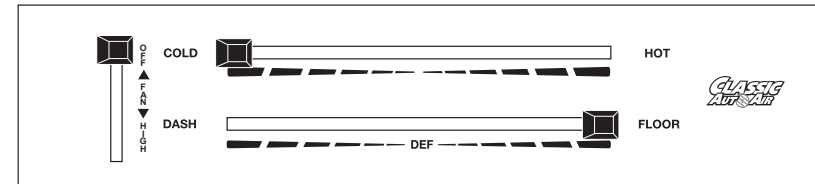

Start by positioning the control knobs as shown:

Fan: Off
Mode: Floor
Temp: Cold

3

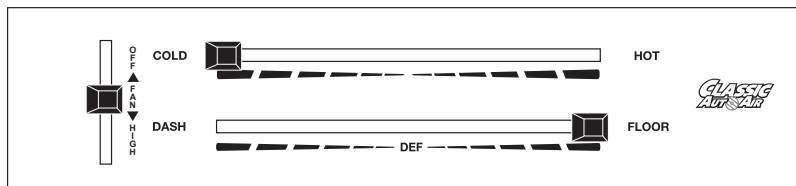

Move Fan Knob to Center...

YOU WILL SEE...

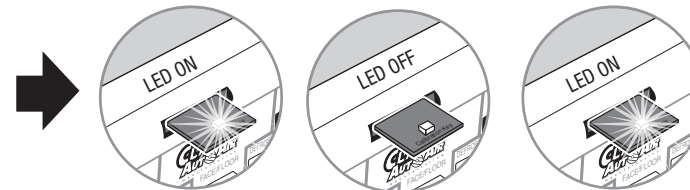

4

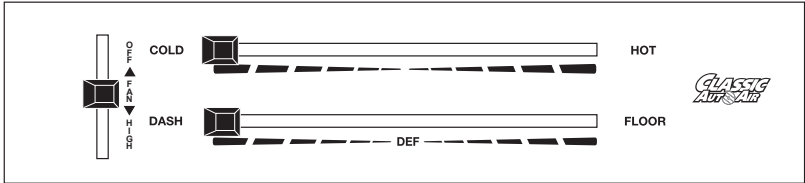

Move MODE knob to DASH
in one motion

AFTER YOU MOVE THE KNOB YOU WILL SEE...

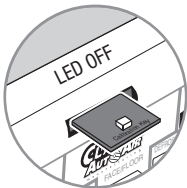

5



Move TEMP knob to HOT
in one motion

AFTER YOU MOVE THE KNOB YOU WILL SEE...

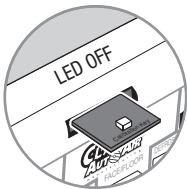

6

You will be able to hear the internal door(s) move back and forth and feel air coming out of the outlets

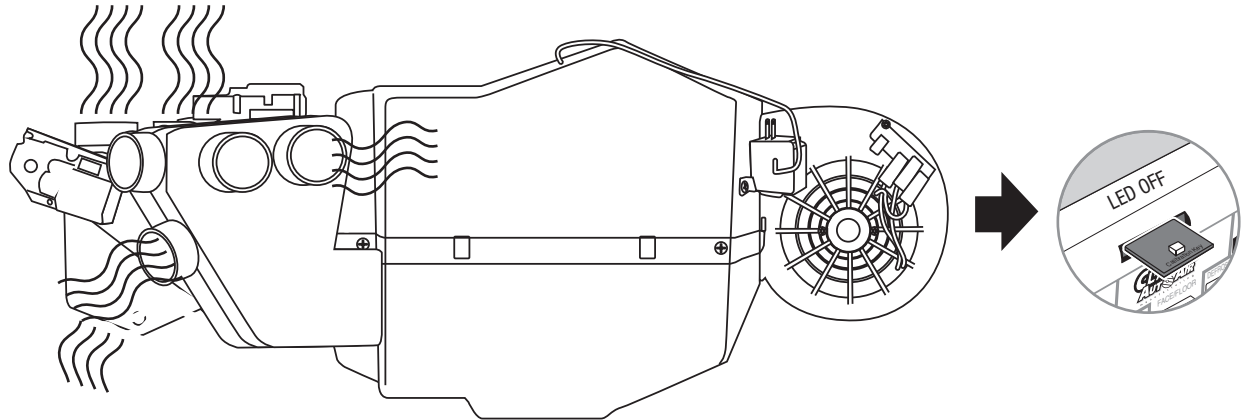

7

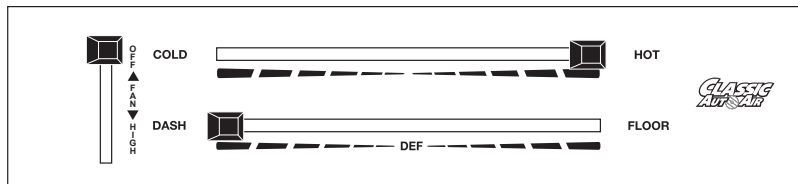

Move FAN knob to OFF

8

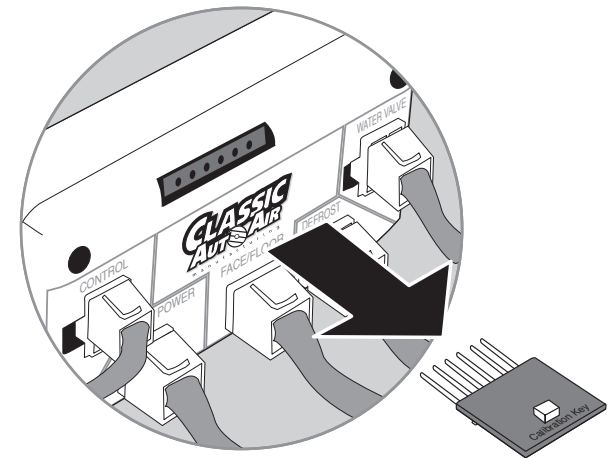

REMOVE CALIBRATION KEY FROM ECU AND
STORE IN A SAFE PLACE

