

Installation Manual

9II COMPRESSOR BRACKET KIT

DOCUMENT #RA-6-100

©2019 ClassicAutoAir / 02.19





PARTS

You will use all of these parts and hardware during the next series of installation steps.



7/8" x 3/8" x 5/8" SPACER

x1



M6 FLAT WASHER

x2



M6 LOCK WASHER

x2



5/16 FLAT WASHER

x1

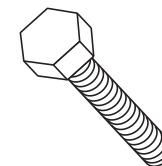

M8 - 1.25 x 55 BOLT

x1

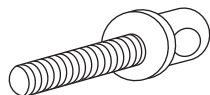

M10 - 1.25 x 45 ADJUSTMENT BOLT

x1



3/8 FLAT WASHER

x18



3/8 - 16 NYLOCK NUT

x10



5/16 - 24 NYLOCK NUT

x1



SHOLDER NUT

x1

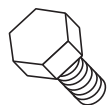

3/8 - 16 x 1 1/4" BOLT

x4

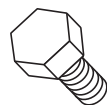

3/8 - 16 x 1" BOLT

x6

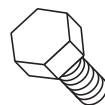

M6 - 1.0 x 12 BOLT

x2

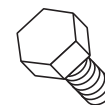

5/16 - 24 x 1" BOLT

x1

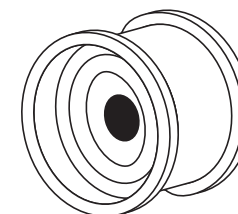

2" PULLEY

x1



3/4" x 7/16" x 1/4" SPACER

x2

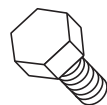

M12 - 1.25 x 35 BOLT

x1



M12 FLAT WASHER

x1

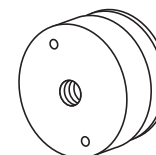

CRANKSHAFT PULLEY

x1

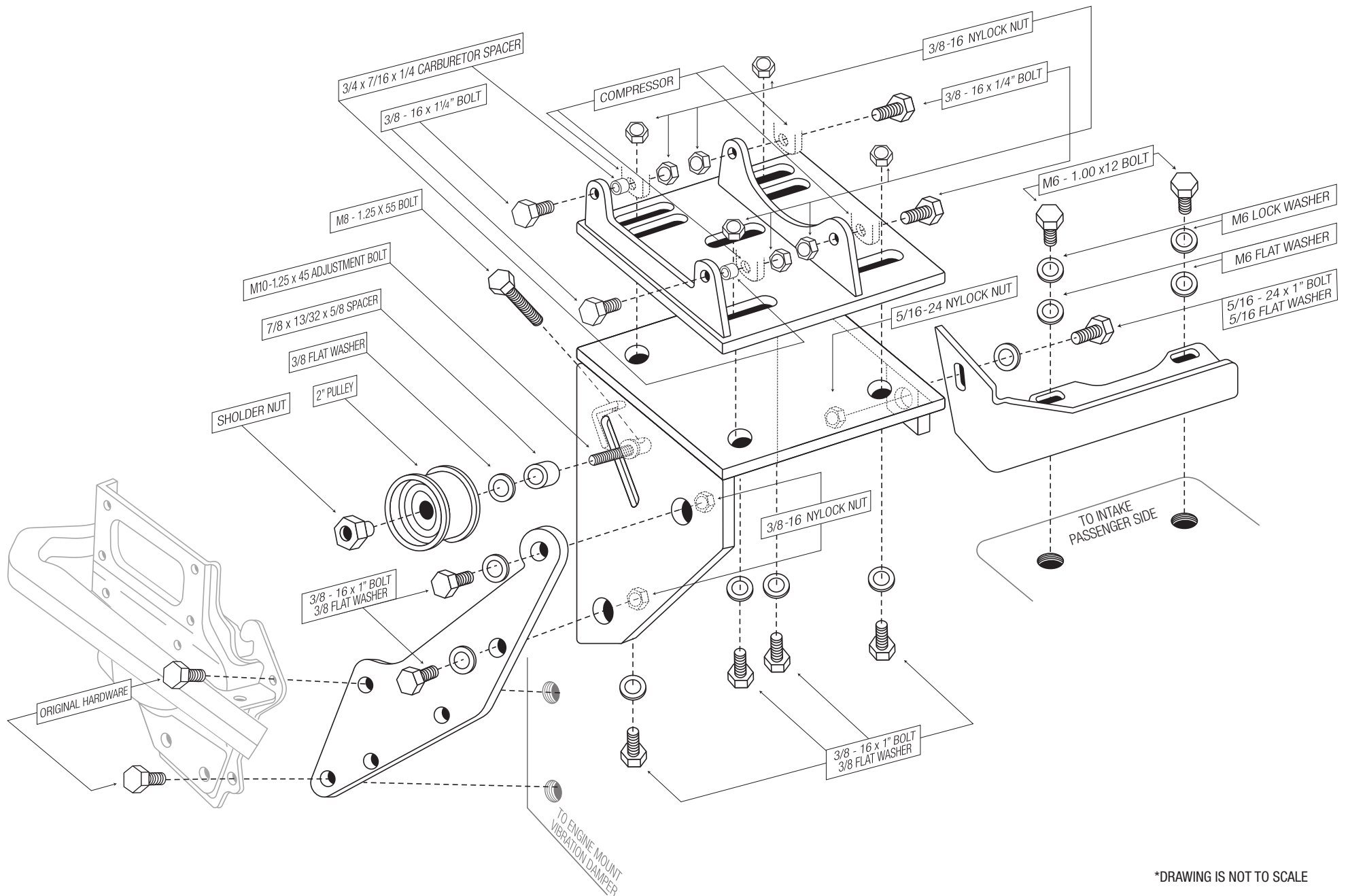

*DRAWING IS NOT TO SCALE

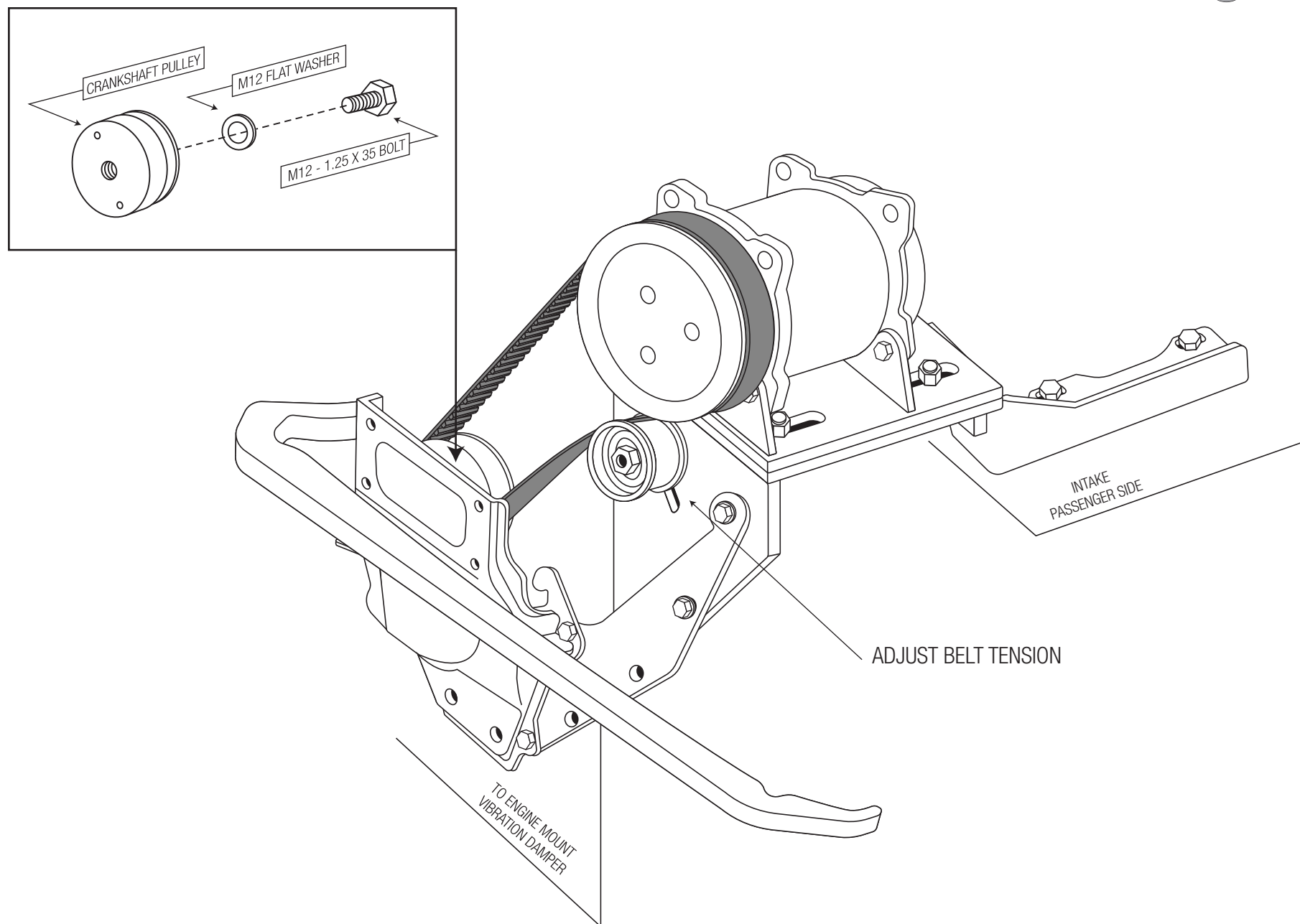

*DRAWING IS NOT TO SCALE

