



Installation Manual

***1969 Firebird** Factory Air*

DOCUMENT #1-2094FA BENCH CALIBRATION INSTRUCTIONS

©2018 ClassicAutoAir / 12.18



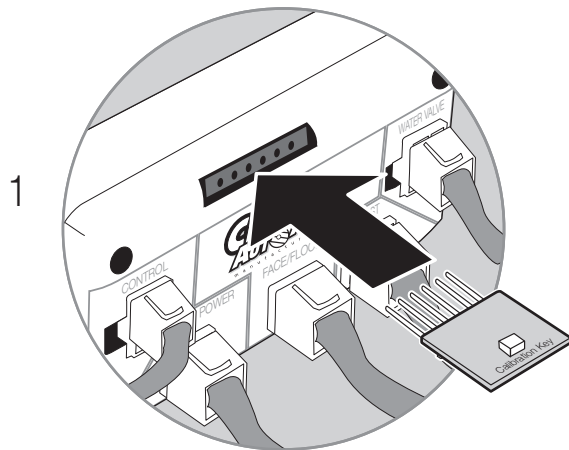

Insert Calibration Key as shown (LED up) into 6-pin connection in ECU

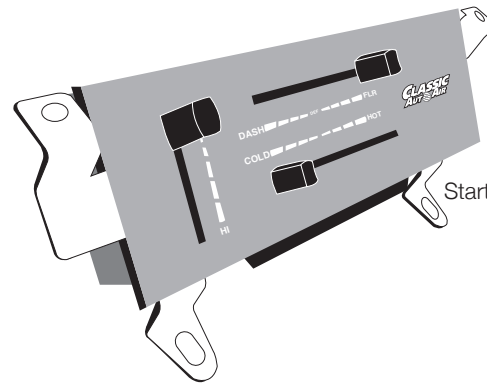

Start by positioning the D.E.R. knobs as shown:
Fan: Off
Mode: Floor
Temp: Cold

3

Move Fan Knob to Center...

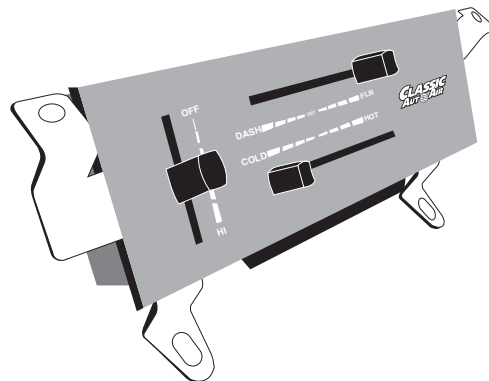

YOU WILL SEE...

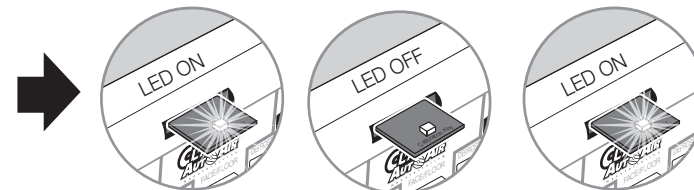

4

Move MODE knob to DASH in one motion

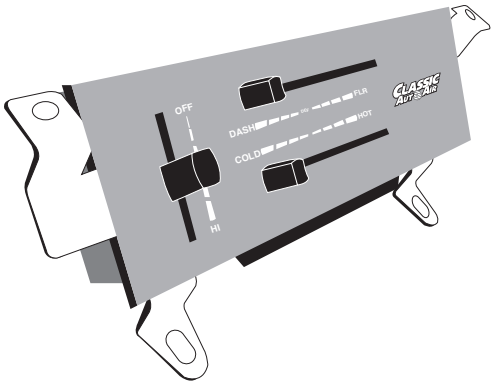

AFTER YOU MOVE THE KNOB YOU WILL SEE...

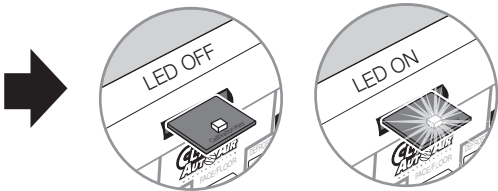

5

Move TEMP knob to HOT in one motion

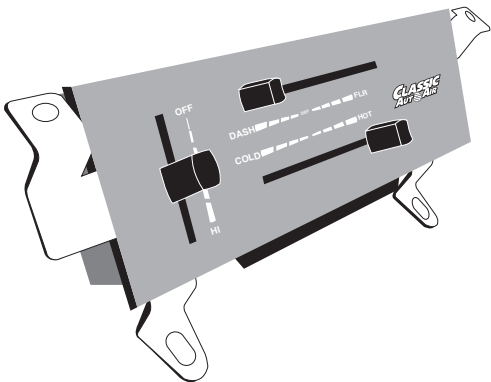

AFTER YOU MOVE THE KNOB YOU WILL SEE...

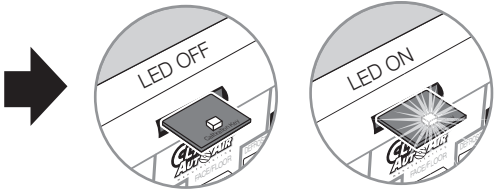

6

You will be able to hear the internal door(s) move back and forth and feel air coming out of the outlets

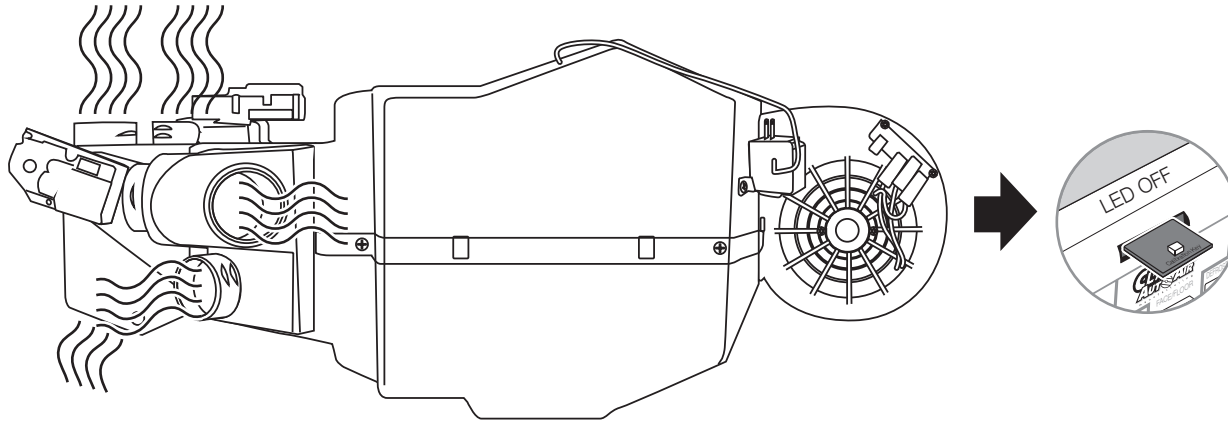

7

Move FAN knob to OFF

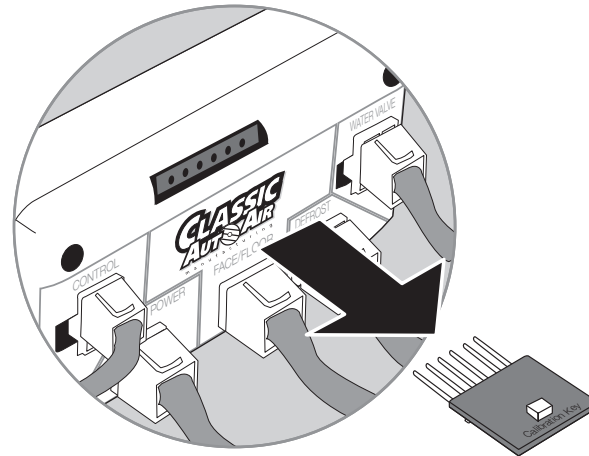
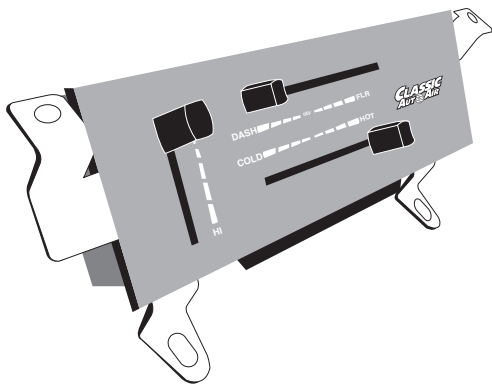

REMOVE CALIBRATION KEY FROM ECU AND
STORE IN A SAFE PLACE

