

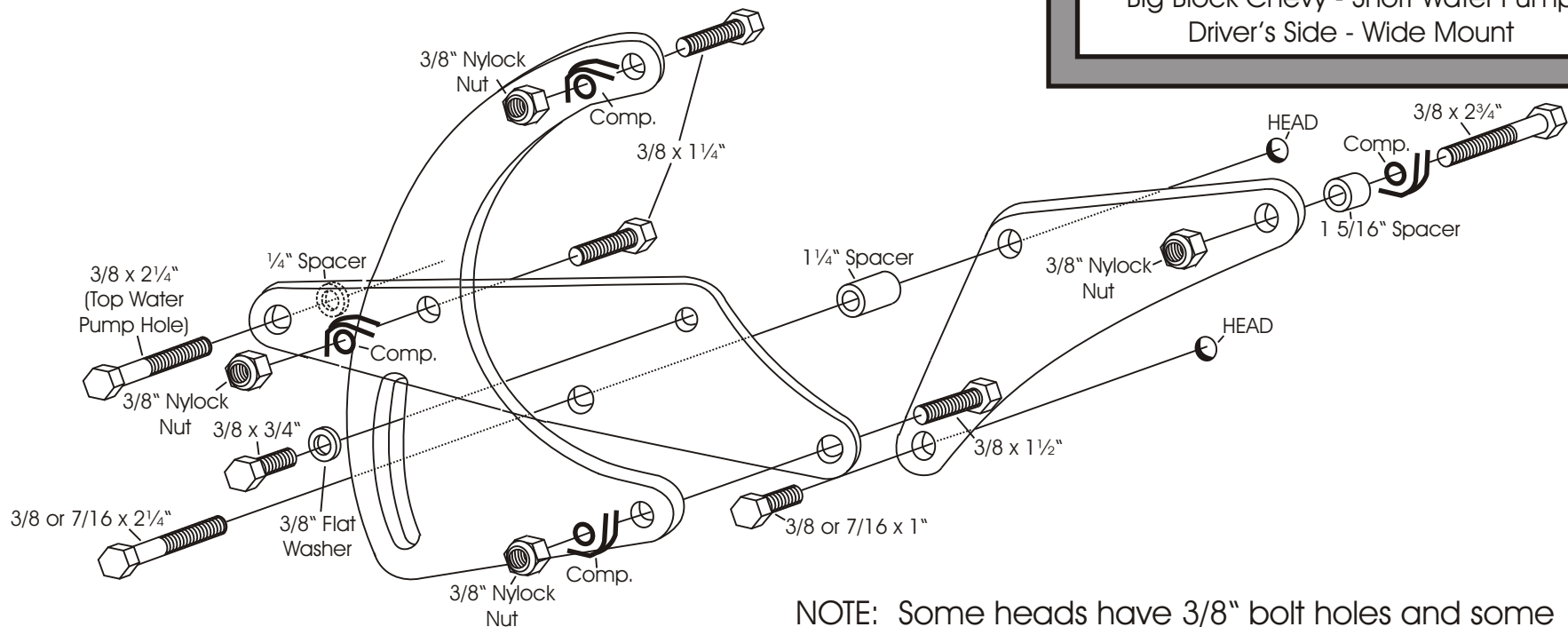

# A.C. COMPRESSOR MOUNT 118L

Big Block Chevy - Short Water Pump  
Driver's Side - Wide Mount



(We use a belt length of 58-59" with this mount on installations in our shop. However; this can vary with the diameter of your pulleys.)

**As with any part of this nature, make sure it fits your application before painting or plating. Parts that have been painted, plated or modified may not be returned.**

**NOTE:** Some heads have 3/8" bolt holes and some have 7/16". This kit includes both sizes of bolts for these holes.

If your head has 7/16" it will be necessary to enlarge the corresponding holes in the mount to 7/16".

When installing the mount, start all bolts and mount the alternator before tightening.

A.C.  
COMPRESSOR  
MOUNT  
118L

Big Block Chevy - Short Water Pump  
Driver's Side - Wide Mount

**ALAN GROVE COMPONENTS, INC.**  
**27070 METCALF ROAD**  
**LOUISBURG, KS 66053**