

ALTERNATOR MOUNT 218R

Big Block Chevy - Short Water Pump Passenger Side - Wide Mount

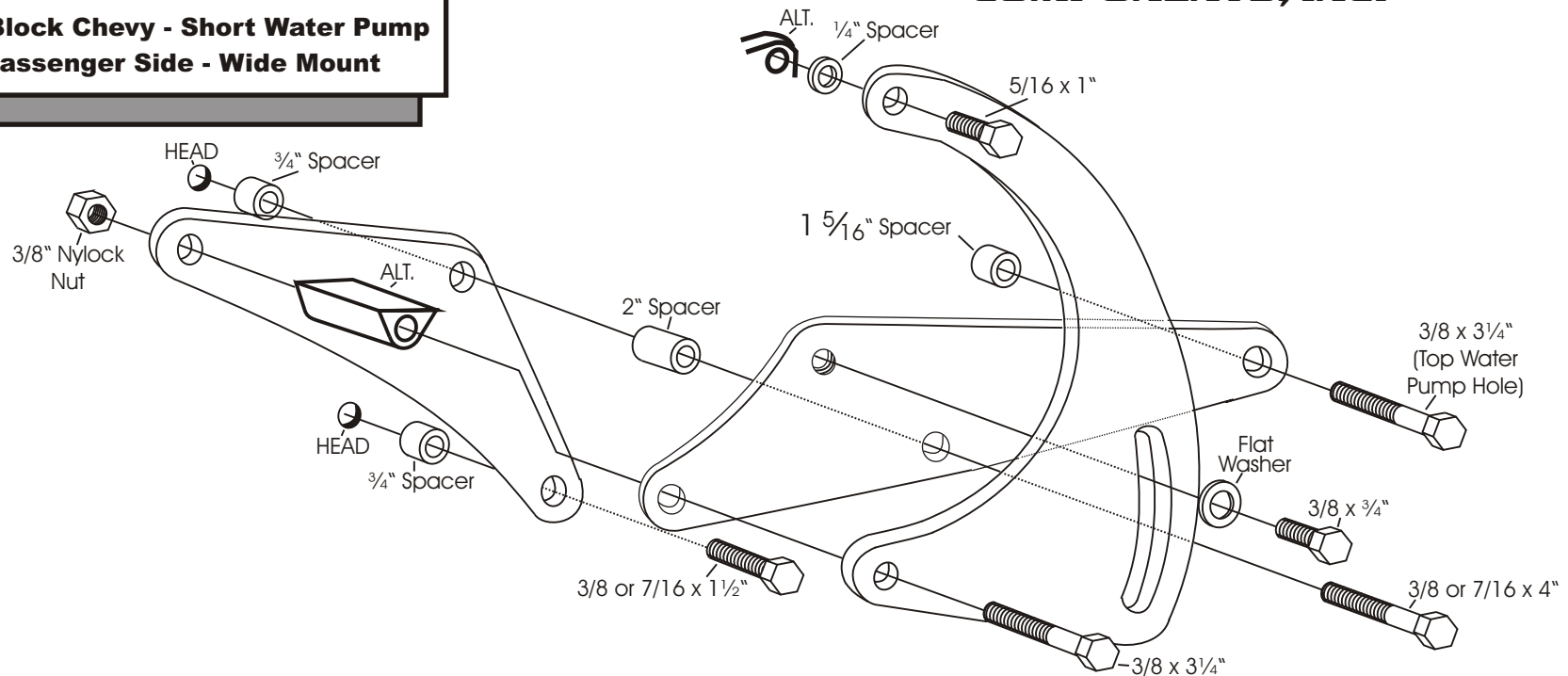

(We use a belt length of 58-59" with this mount on installations in our shop. However; this can vary with the diameter of your pulleys.)

As with any part of this nature, make sure it fits your application before painting or plating. Parts that have been painted, plated, or modified may not be returned.

NOTE: Some heads have 3/8" bolt holes and some have 7/16". This kit includes both sizes of bolts for these holes.

If your head has 7/16" it will be necessary to enlarge the corresponding holes in the mount to 7/16".

When installing the mount, start all bolts and mount the compressor before tightening.

ALTERNATOR
MOUNT

218R

**Big Block Chevy - Short Water Pump
Passenger Side - Wide Mount**

**ALAN GROVE COMPONENTS, INC.
27070 METCALF ROAD
LOUISBURG, KS 66053**