

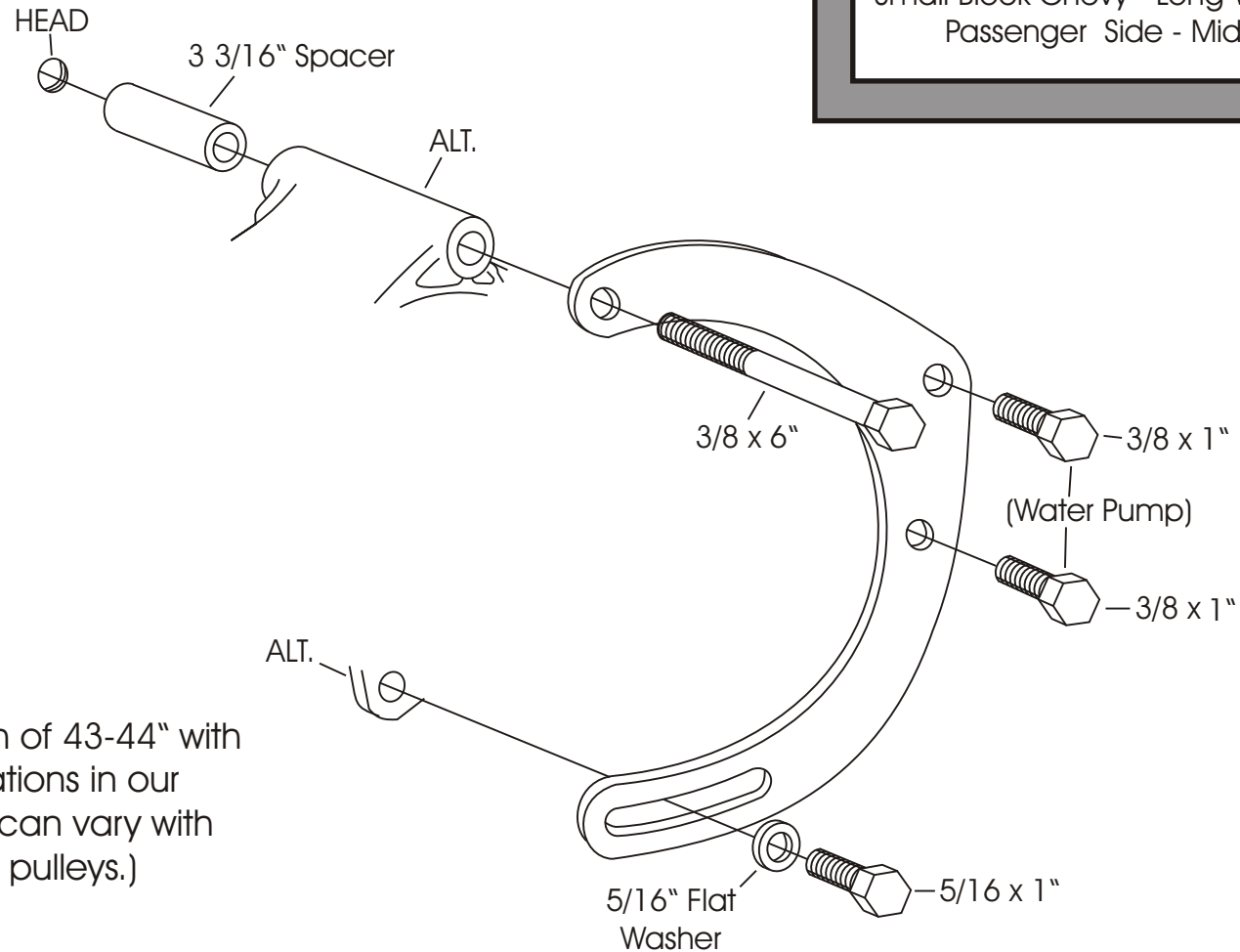

# ALTERNATOR MOUNT 215R

Small Block Chevy - Long Water Pump  
Passenger Side - Mid-Mount



(We use a belt length of 43-44" with this mount on installations in our shop. However; this can vary with the diameter of your pulleys.)

**As with any part of this nature, make sure it fits your application before painting or plating. Parts that have been painted, plated or modified may not be returned.**

ALTERNATOR  
MOUNT  
215R

Small Block Chevy - Long Water Pump  
Passenger Side - Mid-Mount

**ALAN GROVE COMPONENTS, INC.**  
**27070 METCALF ROAD**  
**LOUISBURG, KS 66053**